

Last modified: 28/08/2020 11:58:31

Module - TPMS - Baolong (Remove and Replace)

Correction Code 34043202



Warning

If the vehicle has air suspension, activate "Jack" mode on the touchscreen before raising and supporting the vehicle.

Removal

1. Raise and support the vehicle (refer to procedure).



Warning

Do not work on an incorrectly supported vehicle.



Warning

To avoid personal injury, use appropriate equipment when performing this operation.

2. Remove the mid aero shield (refer to procedure).
3. Pull down the rear diffuser for access to the TPMS ECU.
4. Disconnect the electrical harness connector.
5. Remove the TPMS ECU.

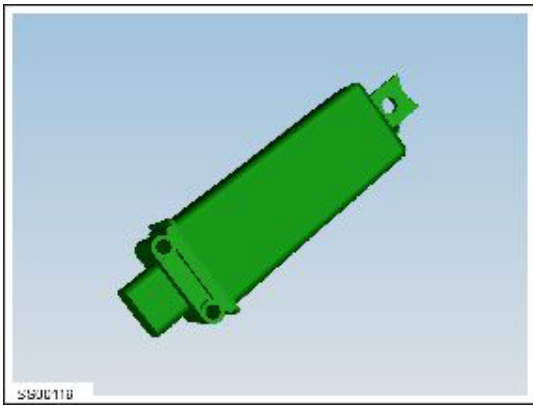

Installation

Installation procedure is the reverse of removal, except for the following:

- Attach the new TPMS ECU to the top of the rear diffuser.



Note

Some vehicles had the TPMS ECU attached to the body. If the TPMS ECU was attached to the body, continue this procedure to install the new ECU on the diffuser. If the TPMS ECU was attached to the diffuser, skip to step 2.



Mounted to rear diffuser



Mounted to body

1. Clean the top surface of the ECU with alcohol.
2. Cut a new pad of dual lock material that is the same size as the original. Place it on the top of the ECU over the part number, leaving the part revision visible.



3. Clean the leading edge of the diffuser panel that faces up. Install a new pad of dual lock material that is the same size as the original, as close as possible to the edge of the diffuser panel.
4. Attach the TPMS ECU as far forward as possible on the rear diffuser panel.

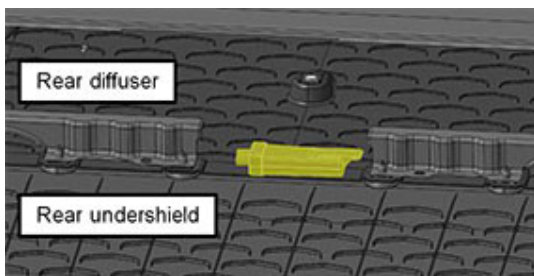

- Reinstall the latest vehicle firmware, or update the firmware if not the latest. See [Software Reinstall](#) or [Firmware Update](#).
- Perform the TPMS sensor ID learn procedure ([refer to procedure](#)).
- Set the proper TPMS thresholds ([refer to procedure](#)).
- Perform a road test.